

3D Magnet

assembly guide

Displate

I Prepare the wall

1. If necessary, clean the wall

with the Cleaning Wipe and wait 10 minutes for it to dry completely.

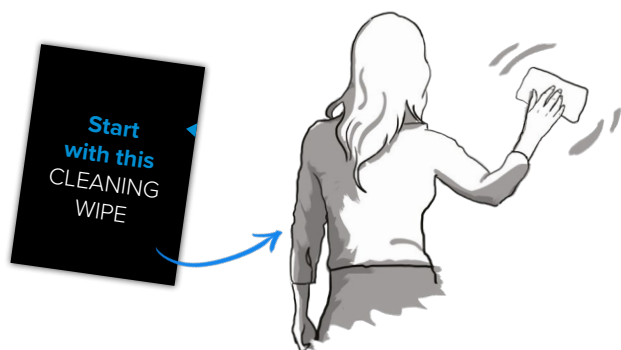

2. Stick the Protective Leaf

Peel off the top of its back paper then slowly stick the Leaf on the wall and tear away the rest of the back paper. Press with your hand to remove any air pockets. **;)!**

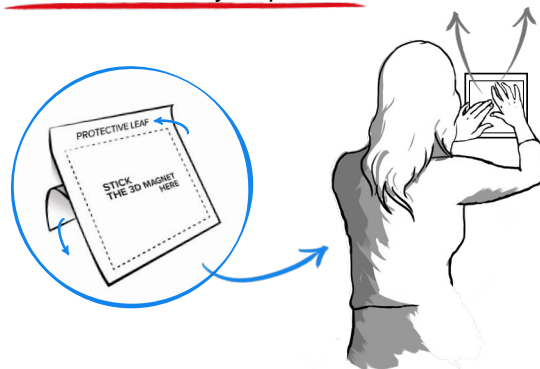

II Get the 3D Magnet into shape

3. With the inside face up bend all six edges

of the slotted flaps upwards.

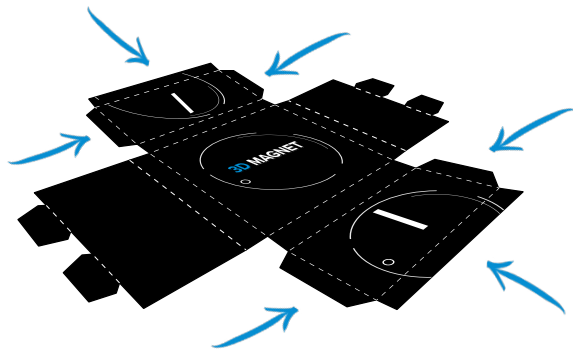

4. Fold both slotted flaps

towards the middle.

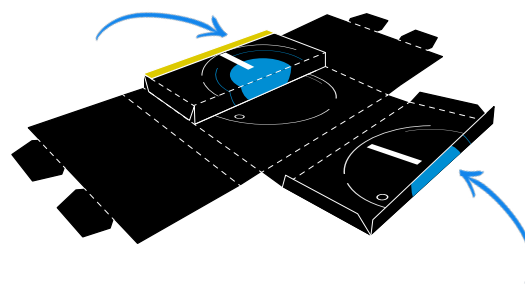

5. Peel off the yellow foil

Bend the other two flaps over. Now insert all four "teeth" into the slots and press the flaps against the sticky stripes.

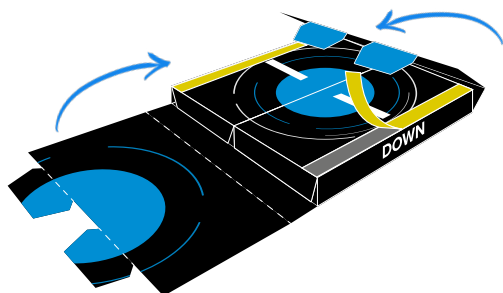

6. There – your 3D Magnet is now ready for action!

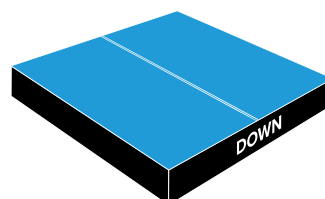

III Stick the 3D Magnet

7. Peel off the blue foil from its surface



8. Set the 3D Magnet according to the Up/Down indicators

then press its sticky side against the Protective Leaf (keep pressing firmly for 5 seconds).

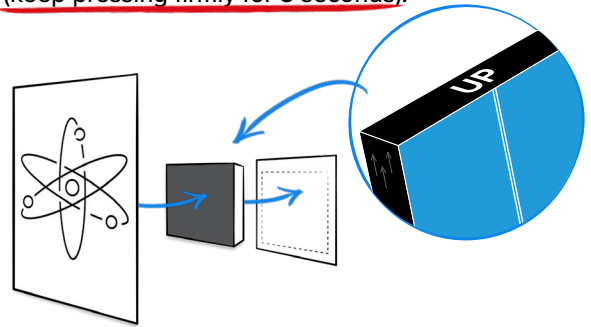

That's it - now hang your Displate and enjoy its rad 3D look!

Great work!

You've set up your new **Displate** like a pro: fast, clean, and with no power tools.

Now just sit back and enjoy the look of this bad boy **standing out** on your wall. Or invite your friends over to show them that **3D Magnet** magic.

Warning: may cause uncontrollable displays of jealousy. But you knew that already.



Share your Displate on Instagram
#displate #displayyourself

Safety



This Leaf and the 3D Magnet are not intended to work on structured or poor quality walls.



Always use your 3D Magnet on flat, vertical surfaces.



Use the 3D Magnet in standard room temperatures (15-28°C or 59-82°F).



Only use the 3D Magnet in places with less than 65% humidity.

Find us



displate.com



In case of any questions, don't hesitate to contact us via mail:
support@displate.com