

MOUNTING LUMINO ON 3D MAGNET

REQUIRED TOOLS (not included)



Power drill with 6 mm drill bit ("1/4")



Hammer



Phillips-head screwdriver or screwdriver bit



Note: The included expansion plugs are not intended for wood. If you want to mount Lumino on wooden or fibreboard walls, please skip steps 1 and 2, and use only the screws.

INSTALLATION

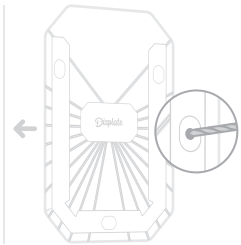

1 Stick the template sticker to the wall and drill 3 holes in the indicated places.

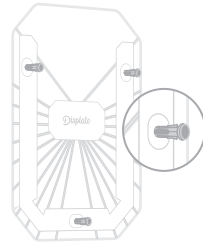

2 Insert 3 plastic expansion plugs into the holes. Push them in by tapping lightly with a hammer.

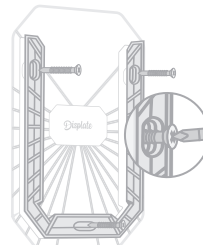

3 Use the included screws to fix the HD Mount to the wall.

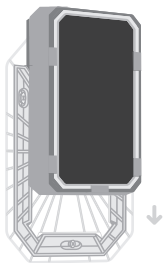

4 Slide the 3D Magnet inside the HD Mount.

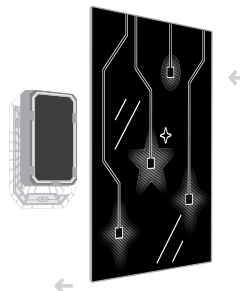

5 Turn on the magic!

Set up your Lumino and mount it on the 3D Magnet. Connect it to the power source, and enjoy!

LUMINO QUICK START GUIDE

CONNECTING A POWER BANK

Stick the magnet to the power bank and mount it on the back of Lumino, outside the 3D Magnet mounting area. Use the shorter USB-C cable to connect the power bank to the Lumino module.

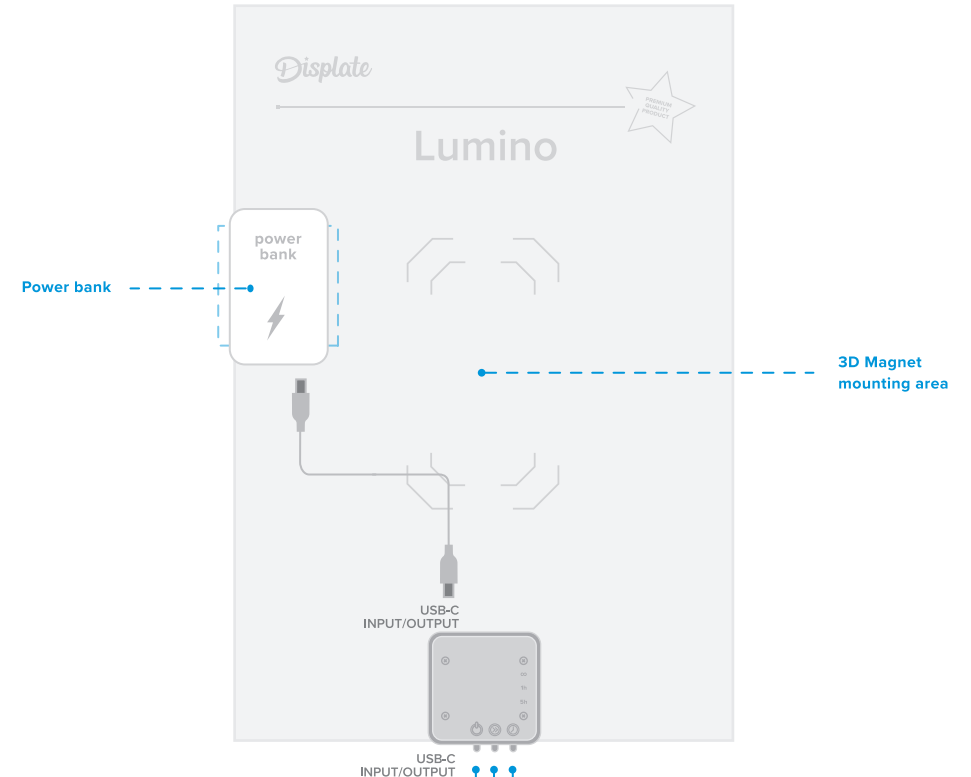

Lumino Timer

Click the timer button to switch between the Lumino working time modes. The Lumino Timer stays at the last selected time mode, even after a restart.

- ∞ Infinite mode - Lumino will work until it is turned off manually.
- 1h Lumino will turn off after one hour.
- 5h Lumino will turn off after five hours.

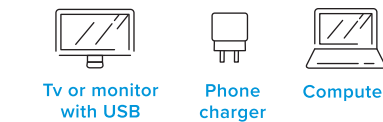

If you are not mounting power bank behind Lumino, please use the longer USB cable to connect Lumino to any device or a wall charger with USB Power Delivery.

ON/OFF

Lumino animation ON/OFF